



Masport Rakaia Catalytic Combustor

Guide for Service technicians and Chimney Sweep

Only a service technician or a chimney sweep should perform the following maintenance tasks. The catalytic combustor, baffle, air tube, and bricks must be removed during the annual chimney sweep.

This procedure for removing & installing the combustor is specific to the Masport Rakaia model.

Step 1 – Remove the Flame Arrester Plate

- First of all, gently lift the damper handle to the "OPEN" position and leave it in that position
- Use the flame plate removal tool supplied with your burner or a small-size flat screwdriver.
- Insert the tool into the holes in the center of the arrester plate and lift the plate upwards, pull forward, and lower the plate out gently.

Step 2 – Remove the Catalytic Combustor from the Masport Rakaia firebox

- Gently lift the front baffle upwards to disengage from the side tab on the side supports and slide the front baffle and the combustor together towards the front.
- Once this front baffle and combustor sub-assembly are well clear of the side supports, lower it and remove it carefully.
- Care should be taken so that the combustor does not drop down. Keep the combustor on a flat surface for inspection and Cleaning.

Alternatively,

- Place your hand up, into the baffle gap, and onto the top of the catalyst. Roll the catalyst forward and through 90° in the forward direction on the front baffle. Gently pull it forward till it tips over the front edge of the front baffle.
- Once tipped over, slowly and gradually remove it from the front baffle and front air deflector gap. Keep it on a flat surface for inspection and Cleaning.
- Remove the front baffle by sliding it forward and bringing it down.

Step 3 – Remove the main baffle and the front air tube

- First, remove the R-Clip of the front air tube. Slide the tube towards the right to unhook the left tab from the pin. Drop and slide the tube on the left side to remove the tube from the firebox.
- The main baffle of Rakaia is locked in place into a small slot on the rear support, on the back wall of the firebox.
- Disengage the main baffle from the slot by giving a tap on the back of the baffle from the bottom.
- Slide it forward, lift one side of the baffle and move it to the raised side. Then lower the other side and bring it further down till it is clear of side supports. Now lower the higher side and remove it out of the firebox.
- Remove all the bricks, keep them in a safe place and empty the firebox.
- This will enable to drop and collect all the chimney dirt into the firebox without removing the main flue pipe.

The fire is now ready for the chimney sweep operation.

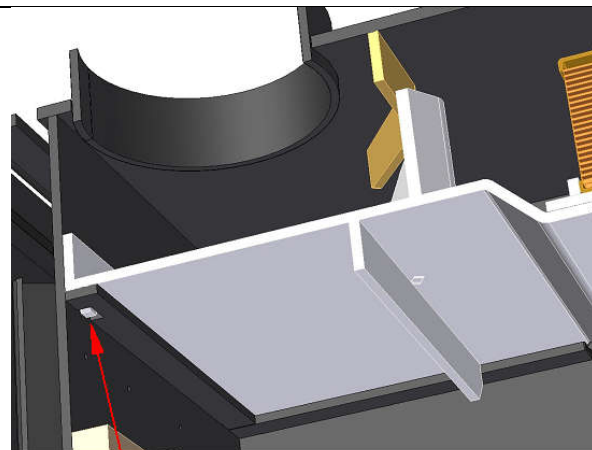

Step 4 – Cleaning the catalytic combustor - Handle the catalytic combustor carefully.

- Use a paint-brush or soft-bristled brush and dust the combustor.
- Use a vacuum cleaner in low to medium suction mode to remove any build-up of fly-ash accumulated on the surface of the combustor.
- Never use water, cleaning solvents, or spray to clean the catalytic combustor. Never use high-pressure air to clean as this may damage the fine plates of the combustor. Do not scrape the inside walls of the combustor with any hard tool. The use of such a method will void the warranty of the Rakaia ULEB.
- If the combustor mesh is damaged severely, replace it with the help of an authorised Masport dealer.

Step 5 – After the Chimney has been swept – Clean the firebox chamber thoroughly and install the removed bricks, main baffle, air tube, combustor along with the front baffle, and the arrester plate in the reverse order of removal. Note the various tabs and notches shown in the schematics below for the location of the main baffle, front baffle, locating combustor on the front baffle, and locking arrester plate on the front baffle.

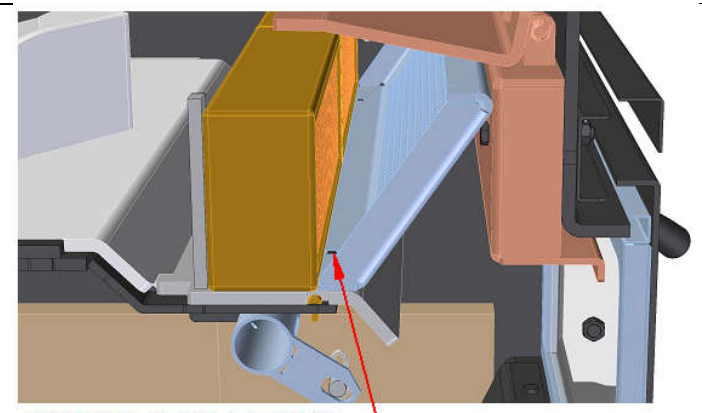
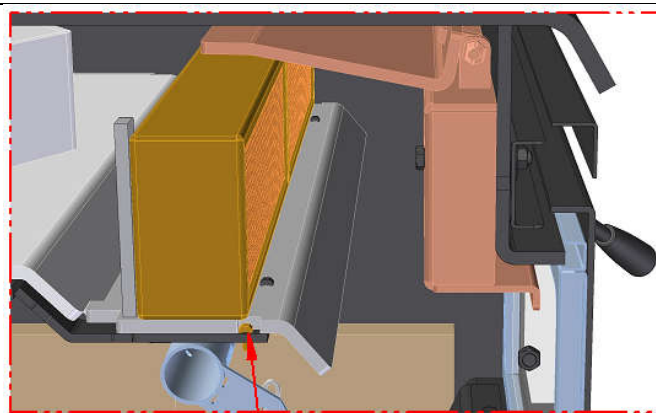
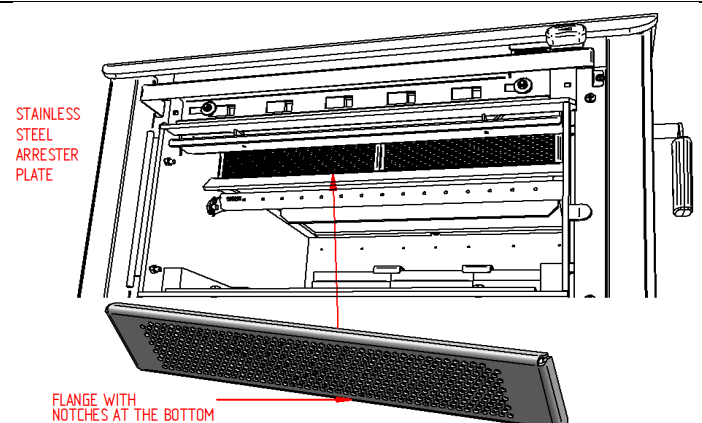
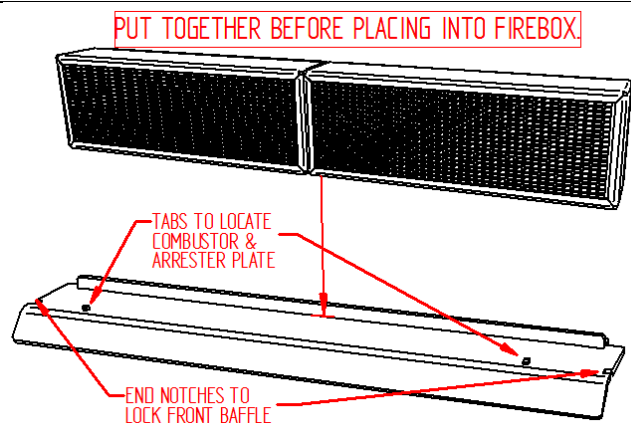

Refer schematic below to check the configuration of all internal firebox components.

