

The logo for Masport Heating, featuring the brand name in a white, bold, sans-serif font with a registered trademark symbol, and the word 'HEATING' in a smaller, all-caps, sans-serif font below it. The logo is set against an orange rectangular background.

Masport[®]
HEATING



AKAROA

FREESTANDING LOW EMISSION WOOD FIRES

The Akaroa breaks the mould of the traditional wood fire. It's sleek, curved design complements a contemporary home while adding a sense of modernity to more traditional decors. The Akaroa's sleek sophistication saw it named as a finalist in the Best Design Awards, 2017. The Best Awards are judged and awarded by the Designers Institute of New Zealand – a group of people who definitely appreciate, and understand, elegant and contemporary design.

masportheating.co.nz





AKAROA

FREESTANDING LOW EMISSION WOOD FIRES

Our Akaroa wood fire reimagines the traditional fireplace, offering a sleek, European design while retaining the warmth and heart of a family wood burner. The Akaroa is ideal for medium-sized homes and offers powerful, clean-burning performance to ensure your family stays cosy throughout the winter. Its taller shape also allows for easier loading of wood. Akaroa is available in two base options: a convenient wood stacker or a built-in, easy-clean ash pan.

- ▶ NES, ECan^ and ORC Airshed I clean air approved
- ▶ Large portrait window with an expansive flame view
- ▶ Available with wood stacker or base with built-in easy clean ash pan.

^Installations limited to specific regions in Canterbury.

Finish	Metallic Black VHT
Space Heat Output**	Suitable for small to medium homes (2-3 bedrooms)
Dimensions w x d x h	481 x 536 x 1025 mm

BASE OPTIONS



Fire Only	981901	981903
Flue Only	GDFLU018M	GDFLU018M
Fire & Flue Pack	AKAROAPACK	AKAROAWSPACK



Clearance Specifications

Minimum distance to heat sensitive materials (mm) when a Masport double skin flue shield is fitted as per Masport specifications.

Model	Space Heat Output	Type of Flue Shield	Type of Floor Protector	A	B	C	D	E	F	G	H	I	J	K	L	M	N	R	W
Akaroa Ash / Woodstacker	SML-MED	MDSS	AFP	100	350	300	117	180	261	591	400	415	715	920	1236	1025	670	566	481

Flue Shields

MDSS Masport Double Skin Flue Shield 600mm long

Floor Protectors

AFP Ash Floor Protector

Masport Steel Floor Protectors

Parallel - 998901 & 998908
Corner - 998904 & 998909

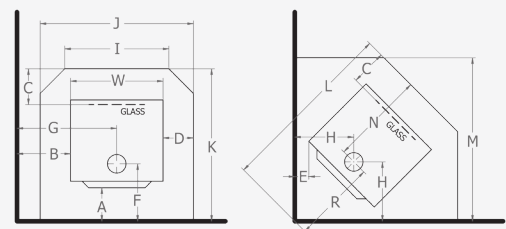

* Refer to the specifications sheet for full product details and compliance testing

**Space Heat Output is only a guide based on homes with average insulation, window area, and 2.4m ceiling heights. Differences in these factors, as well as others like, geographical location, layout of the house, living room size, type of windows all play a part in choosing the right model for your heating needs. Consult your dealer or installation contractor for more information.



Glen Dimplex New Zealand Ltd PO Box 58473, Botany, Auckland

Glen Dimplex New Zealand Ltd's policy is one of continuous development. We reserve the right to change size and specifications without notice. For the latest product information and warranty details please refer to www.masportheating.co.nz. Please refer to the installation and operation instructions before having your Masport Wood Fire installed. A full set of these instructions is supplied with each fire.

masportheating.co.nz

April 2024